

**VALVULA DE MEMBRANA**  
CLAMP/CLAMP

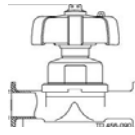

DN: 1/2", 3/4", 1", 1 1/2", 2"

**VALVULA DE MARIPOSA**  
CLAMP /CLAMP

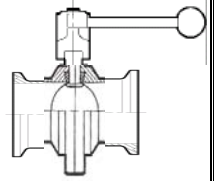

DN: 1", 1 1/2", 2", 2 1/2", 3", 4", 6"

**VALV. DE BOLA SANITARIA**  
CLAMP/CLAMP

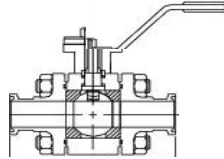

DN: 1/2", 3/4", 1", 1 1/2", 2", 2 1/2", 3", 4"

**VALV.DE BOLA DRENAJE**  
CLAMP/ CLAMP



DN: 1/2", 3/4", 1", 1 1/2", 2", 2 1/2", 3", 4"

**ABRAZADERA CLAMP**

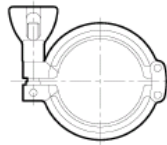

K12 DN: 1/2", 3/4", 1", 1 1/2", 2", 3", 4"  
K12 D NW: 10/20, 25/40, 50, 65, 80, 100, 125, 150

**ABRAZADERA CLAMP**  
ALTA PRESION

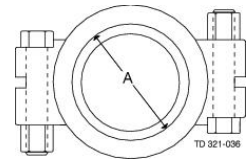

DN: 1", 1 1/2", 2", 2 1/2", 3", 4", 6"

**ABRAZADERA CLAMP**

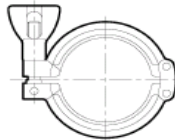

DN: 8-15, 20-25, 32-40, 50, 65, 80, 100, 125, 150, 200, 250

**CASQUILLO CIEGO CLAMP**

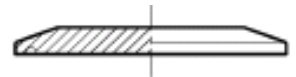

DN: 8-15, 20-25, 32-40, 50, 65, 80, 100, 125, 150, 200, 250

**CASQUILLO CLAMP**

Standard BS 4825 S/Norma A270  
D ( Acabado DIN/NW ) Standard DIN 32676 S/ Norma 11850

TC

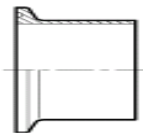

DN	TUBO	Long.	TC	NW	TUBO	Long.	TC
1/2"	12,7x1,65	28,0	25,0	10	12x1,5	18,0	34,0
3/4"	19,5x1,65	28,0	25,0	15	18x1,5	18,0	34,0
1"	25,4x1,65	28,6	50,4	20	22x1,5	18,0	34,0
1 1/2"	38,1x1,65	28,6	50,4	25	28x1,5	21,5	50,4
2"	50,8x1,65	28,6	64,0	32	34x1,5	21,5	50,4
2 1/2"	63,5x1,65	28,6	77,5	40	40x1,5	21,5	50,4
3"	76,2x1,65	28,6	91,0	50	52x1,5	21,5	64,0
4"	101,6x 2,11	28,6	119,0	65	70x2	28,0	91,0
6"	152,4x2,77	28,6	167,1	80	85x2	28,0	106,0
8"	203,2x2,77	28,6	217,5	100	104x2	28,0	119,0
10"	254,0x2,77	28,6	268,5	125	129x2	28,0	155,0
12"	304,8x2,77	28,6	319,8	150	154x2	28,0	183,0

### CASQUILLO CLAMP

AMP ASME BPE , PL Ra. 0,5 interno para Pharma  
 ISO ISO 2852 fot tube std. According ISO 1127

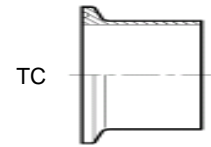

DN	TUBO	Long.	TC	ISO	TUBO	Long.	TC
1/2"	12,7x1,65	44,5	25,0	8	13,5X1,6	21,5	25,0
3/4"	19,5x1,65	44,5	25,0	10	17,2x1,6	21,5	25,0
1"	25,4x1,65	44,5	50,4	15	21,3x1,6	21,5	34,0
1 1/2"	38,1x1,65	44,5	50,4	20	26,9x1,6	21,5	50,4
2"	50,8x1,65	57,15	63,9	25	33,7x2,0	21,5	50,4
2 1/2"	63,5x1,65	57,15	77,5	32	42,4x2,0	21,5	64,0
3"	76,2x1,65	57,15	90,9	40	48,3x2,0	21,5	64,0
4"	101,6x 2,11	57,15	118,9	50	60,3x2,0	21,5	77,5
6"	152,4x2,11	76,20	166,68	65	76,1x2,0	21,5	91,0
				80	88,9x2,3	21,5	106,0
				100	114,3x2,3	28,5	144,4
				125	139,7x2,3	28,5	155,0
				150	168,3x2,6	28,5	183,0

### PORTAMANGUERA CLAMP

PULIDO INT/EXT Ra 0,8  
 Aisi 316L

DN: 1/2", 3/4", 1", 1 1/2", 2", 2 1/2", 3", 4"

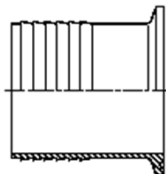

### CASQUILLO CIEGO C

PULIDO INT/EXT Ra 0,8  
 Aisi 316L

1/2", 3/4", 1", 1 1/2", 2", 2 1/2", 3"

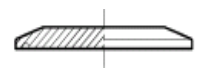

### CODO CLAMP

PULIDO INT/EXT Ra 0,8  
 Aisi 316L

DN: 1/2", 3/4", 1", 1 1/2", 2", 2 1/2", 3", 4"

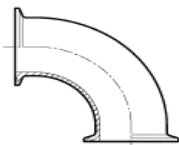

### TE CLAMP

PULIDO INT/EXT Ra 0,8  
 Aisi 316L

DN: 1/2", 3/4", 1", 1 1/2", 2", 2 1/2", 3", 4"

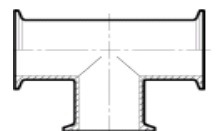

### CODO CLAMP SOLDAR

PULIDO INT/EXT Ra 0,8  
 Aisi 316L

DN: 1/2", 3/4", 1", 1 1/2", 2", 2 1/2", 3", 4"

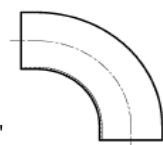

### TE CLAMP SOLDAR

PULIDO INT/EXT Ra 0,8  
 Aisi 316L

DN: 1/2", 3/4", 1", 1 1/2", 2", 2 1/2", 3", 4"

